

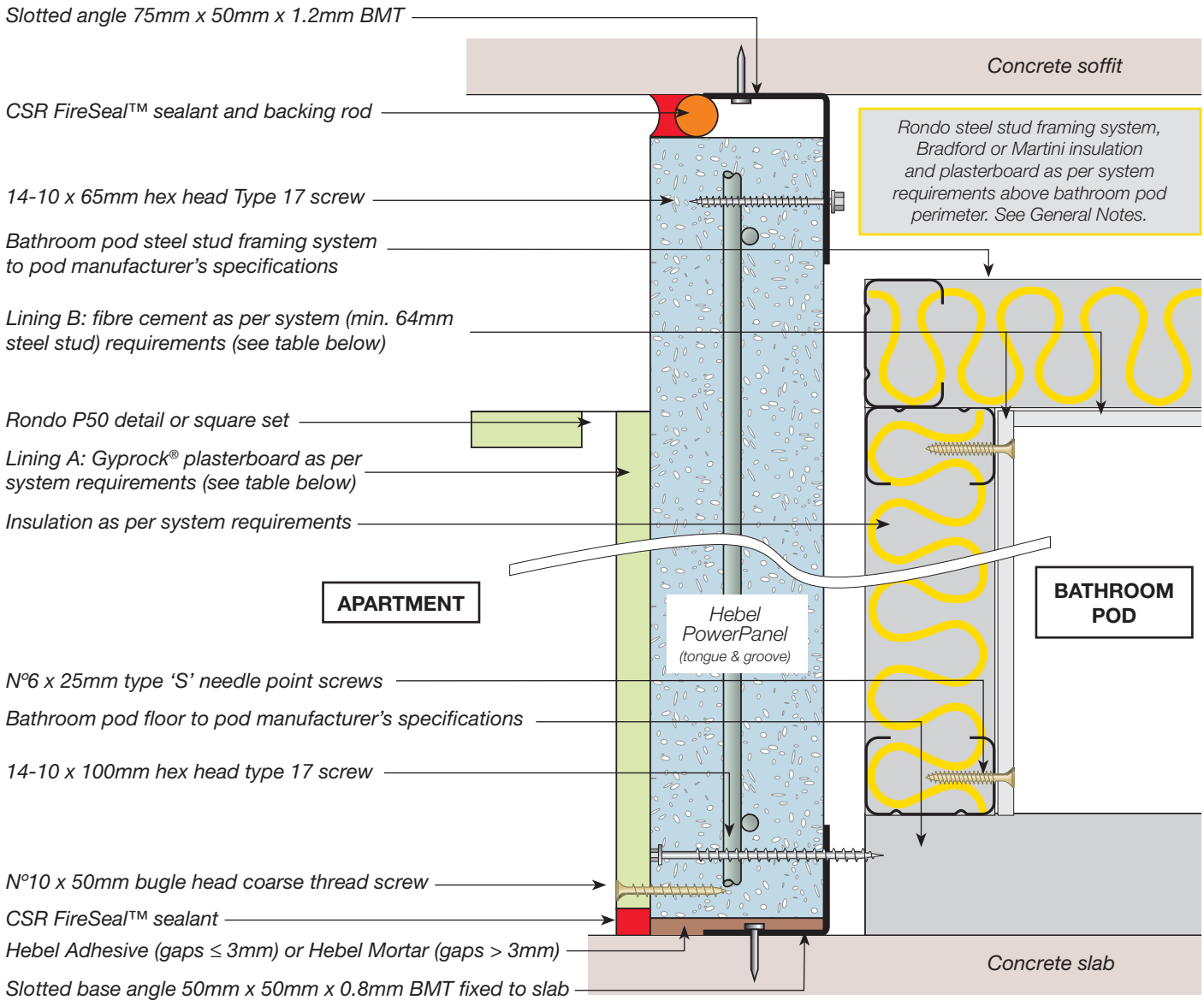

# INTERTENANCY WALL

bathroom pod one side



System	Application	FRL <sup>(A)</sup>	Wall lining A	Cavity width (mm)	Wall lining B	Insulation <sup>(C)</sup>	Acoustic rating $R_w + C_{tr}$ <sup>(B)</sup>	Wall width (mm)
HEB 1451	Apartment to Bathroom Pod	-/90/90 for wall heights up to 3.3m	13mm Gyprock CD	20	6mm fibre cement	75mm Bradford Acoustigard 11, 75mm Martini Prime 75, or 70mm spray foam (11kg/m <sup>3</sup> )	≥50dB	178

**NOTES:**

(A) FRL values should be read in conjunction with CSIRO fire opinion FCO-3036. For walls >3.3m and ≤ 4.65m, Hebel PowerPanel caged tongue & groove will achieve a FRL of -/120/120.

(B) Acoustic values should be read in conjunction with Acoustic Logic acoustic assessment report 20151586.3/0707A/R5/GW.

(C) Where bathroom pods are installed alongside a facade wall and one pod wall forms part of the facade wall construction, the insulation used in this wall must be deemed non-combustible.

**GENERAL NOTES**

- Insulation and plasterboard are required around bathroom pod perimeter to concrete soffit.
- For more construction and product information refer to Hebel Design & Installation Guide for High Rise Apartments Hotels Student Accommodation Commercial - Corridor, Intertenancy, Shaft & Service Walls (HELIT117).



For more information or to speak to a Hebel representative call:

**1300 369 448** or [www.hebel.com.au](http://www.hebel.com.au)

